

ART. 1665

Bordo vasca / Bath-side group / Bain-douche sur gorge / Wannenrandbatterie /
Bateria horizontal bañera

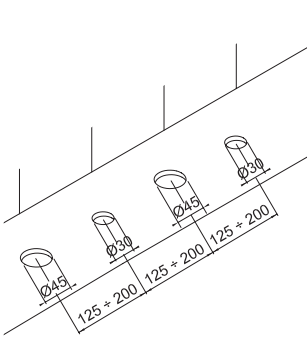

1.

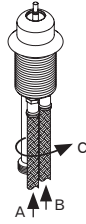

2.

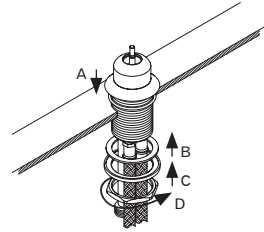

3.

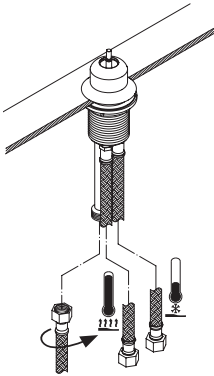

4.

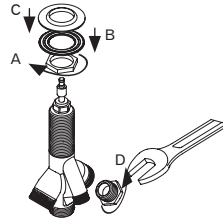

5.

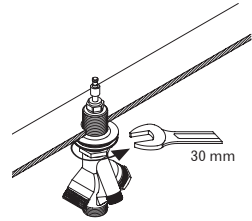

6.

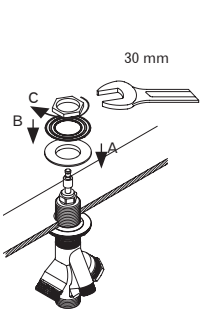

7.

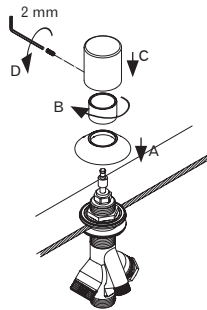

8.

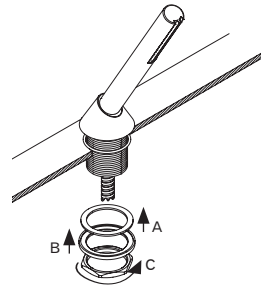

9.

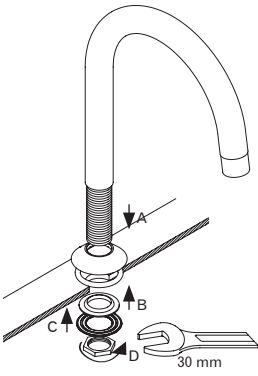

10.

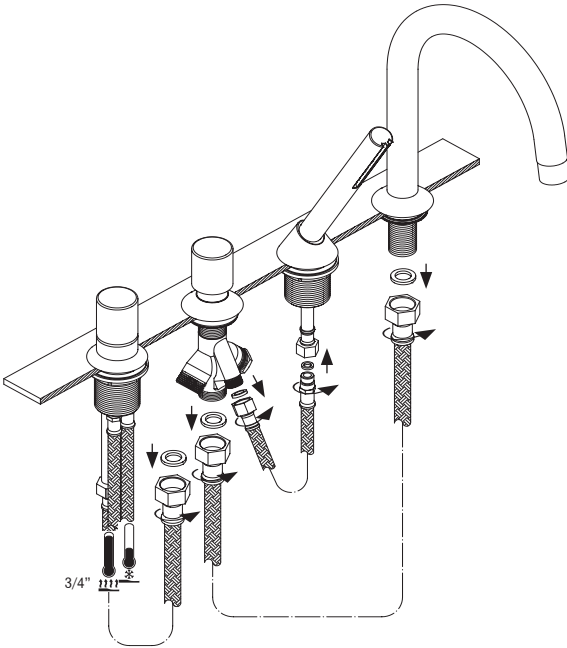

11.

Regolazioni / Adjustments / Ajustements / Anpassungen / Ajustes

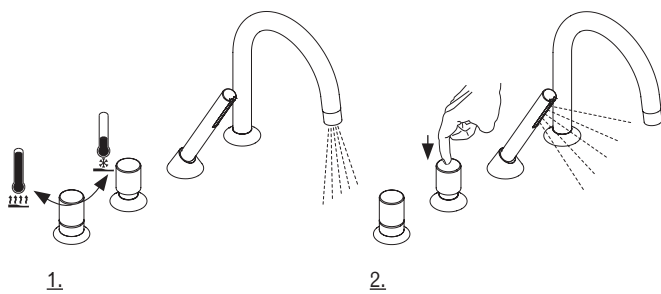

Sostituzione cartuccia / Cartridge replacement / Remplacement de la cartouche
Auswechseln der Kartusche / Sustitucion del cartucho
Per art. 1665

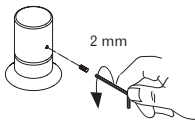

1.

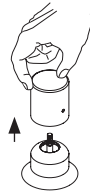

2.



3.



4.



5.

Rimontare seguendo il procedimento inverso (5-4-3-2-1).
Replace following the instructions in reverse order (5-4-3-2-1).
Re-installer au contraire du procédé (5-4-3-2-1).
Die umgekehrte Vorgehensweise folgen um die Teil wieder zu installieren (5-4-3-2-1).
Colocar según el procedimiento inverso (5-4-3-2-1).

Sostituzione aeratore / Substitute aerator / Remplacement de l'aérateur / Den Lüfter auswesceln /
Sustituir el aireador
Per art. 1865

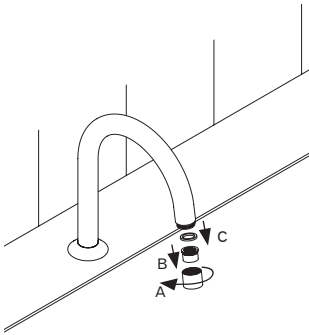

1.

Rimontare seguendo il procedimento inverso (C-B-A)
Replace following the instructions in reverse order (C-B-A)
Re-installer au contraire du procédé (C-B-A)
Die umgekehrte Vorgehensweise folgen um die Teil wie der zu installieren (C-B-A)
Colocar según el procedimiento inverso (C-B-A)