

VIEGA GROUP



Multiplex drain/overflow

Model 6162.45



Multiplex drain/overflow

Visign M5

flat version; only 33 mm space required behind the bathtub

Components

chrome-plated rotatable rosette, chrome-plated valve cone, odour trap, drain elbow 45°, chrome-plated valve

Technical data

Water seal height 50 mm

Drainage capacity accumulation height 300 mm 0.92 l/s

Spillway capacity accumulation height 60 mm over mid of spill hole 0,63 l/s

Note

See current overview for instructions for use!

quality controlled in accordance with DIN EN 274

Model 6162.45



MANUALS

year of construction from 06/2015

Article

DN	BWL	L	H	SB	B52	PU	Article
40/50	560	100–260	180–400	✓	✓	24	101 909

BWL = Bowden wire length

SB = Standard bathtub

B52 = for bathtub with Ø 52 drain
hole

Exploded view

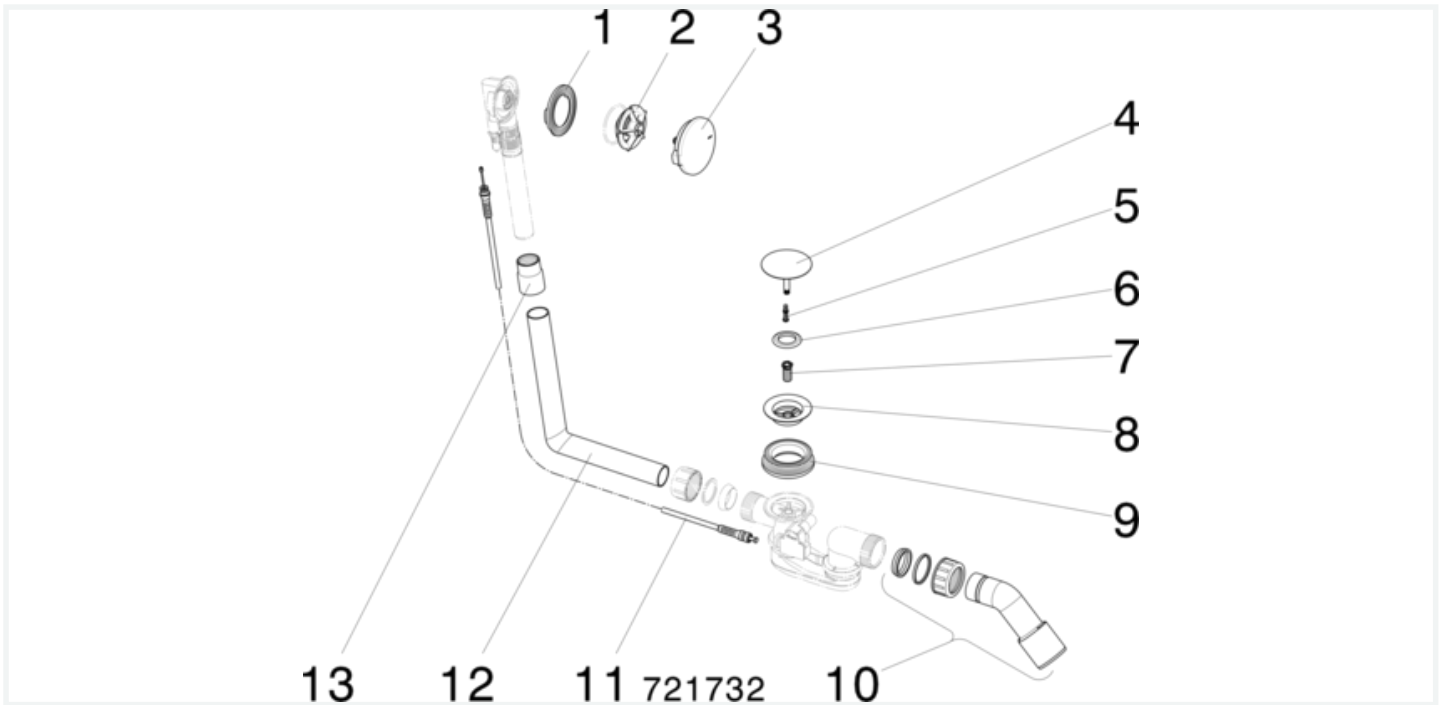

- 1 - Seal - Model 6162.475 (734619)
- 2 - Flange - Model 6168.11 (749972)
- 3 - Rotatable rosette - Model 6162.12 (734602)
- 4 - Valve cone - Model 6168-035 (215392)
- 5 - Adjusting screw - Model 6151-912 (110277)
- 6 - Seal - Model 6162-268 (104740)
- 7 - Screw - Model 6162.45-593 (122485)

- 8 - Valve top - Model 6162-955 (119812)
- 9 - Seal - Model 6162.473 (398378)
- 10 - Drain elbow 45° - Model 6162.99 (719265)
- 11 - Bowden cable - Model 6162.19
- 12 - Overflow pipe - Model 6176-651 (113124)
- 13 - Coupling - Model 6167-417 (117245)

Spare parts list



1 - Seal
Model Number 6162.475



2 - Flange
Model Number 6168.11



3 - Rotatable rosette
Visign M5/R5
Model Number 6162.12



4 - Valve cone
Model Number 6168-035



5 - Adjusting screw
Model Number 6151-912



6 - Seal
Model Number 6162-268



7 - Screw
Model Number 6162.45-593



8 - Valve top
Model Number 6162-955



9 - Seal
Model Number 6162.473



10 - Drain elbow 45°
Model Number 6162.99



11 - Bowden cable
Model Number 6162.19



12 - Overflow pipe
Model Number 6176-651



13 - Coupling
Model Number 6167-417

Accessory list



Multiplex extension set
Model Number 6161.7

Sticker

DN	BWL	L	H	SB	B52	warehouse labels (box)		warehouse labels (sticker)		Article
40/50	560	100–260	180–400	✓	✓	+	≲	+	≲	101 909

BWL = Bowden wire length

SB = Standard bathtub

B52 = for bathtub with Ø 52 drain hole

CAD files

DWG2D File format
(Please choose)

DN	BWL	L	H	SB	B52	file size			Article
40/50	560	100–260	180–400	✓	✓	1.6 MB	+	≲	101 909

BWL = Bowden wire length

SB = Standard bathtub

B52 = for bathtub with Ø 52 drain hole

Downloads

► **Catalog** (1)

PDF

Viega Visign. Technology meets Design.
File size: 4.1 MB | File type: PDF

► **Application technology** (1)

PDF

Application Technology 2017. Volume II: Plastic Piping systems, pre-wall and drainage

Application technology 2018

File size: 21.2 MB | File type: PDF

► **Brochure (2)**

PDF

Viega drainage technology - A constant stream of new ideas

File size: 2.5 MB | File type: PDF

PDF

File size: 1.6 MB | File type: PDF

Assembling

**User manual Multiplex drain/overflow**

Model 6162.45

Model Number: 6162.45

PDF

User manual Multiplex drain/overflow

Model Number: 6162.45 | File...

Copyright Notice:

Sanitary and heating systems from Viega are recognized branded products: product quality with system warranty.

Furthermore, liability agreements have been concluded with the ZVSHK (Zentralverband Sanitär Heizung Klima) and the BTGA (Bundesindustrieverband Technische Gebäudeausrüstung e. V.) for Viega branded products. Exceptions: brass threaded fittings and brass tap extensions. The selection of raw materials for high product standards, modern production, the use of auxiliary equipment as well as packaging occurs with due care and attention to reasonable economic and ecological principles. In doing so, Viega products are well known among architects, planners, wholesale traders and specialist companies involved in building services technology. Sales of Viega products are traditionally completed via wholesale specialists.

The Viega quality management system is certified in accordance with DIN EN ISO 9001.

The illustrations and details in this document are not binding. We reserve all rights for technical amendments. All details concerning materials refer to the parts which come into contact with water. All measurements specify mm. PU = packaging units.

References on the viega.com website to "Viega", depending on the particular context, refer either to the Viega corporate group, comprising Viega GmbH & Co. KG as well as their direct or indirect subsidiaries, or to the Viega brand. The individual companies of the Viega group are separate and independent legal entities and as such act independently. "Viega" is therefore not necessarily to be interpreted as a reference to a specific company of the Viega group.