

手配出来ないパーツも含まれるため、取り扱い注意

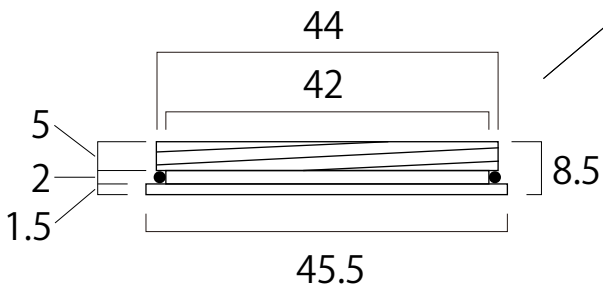
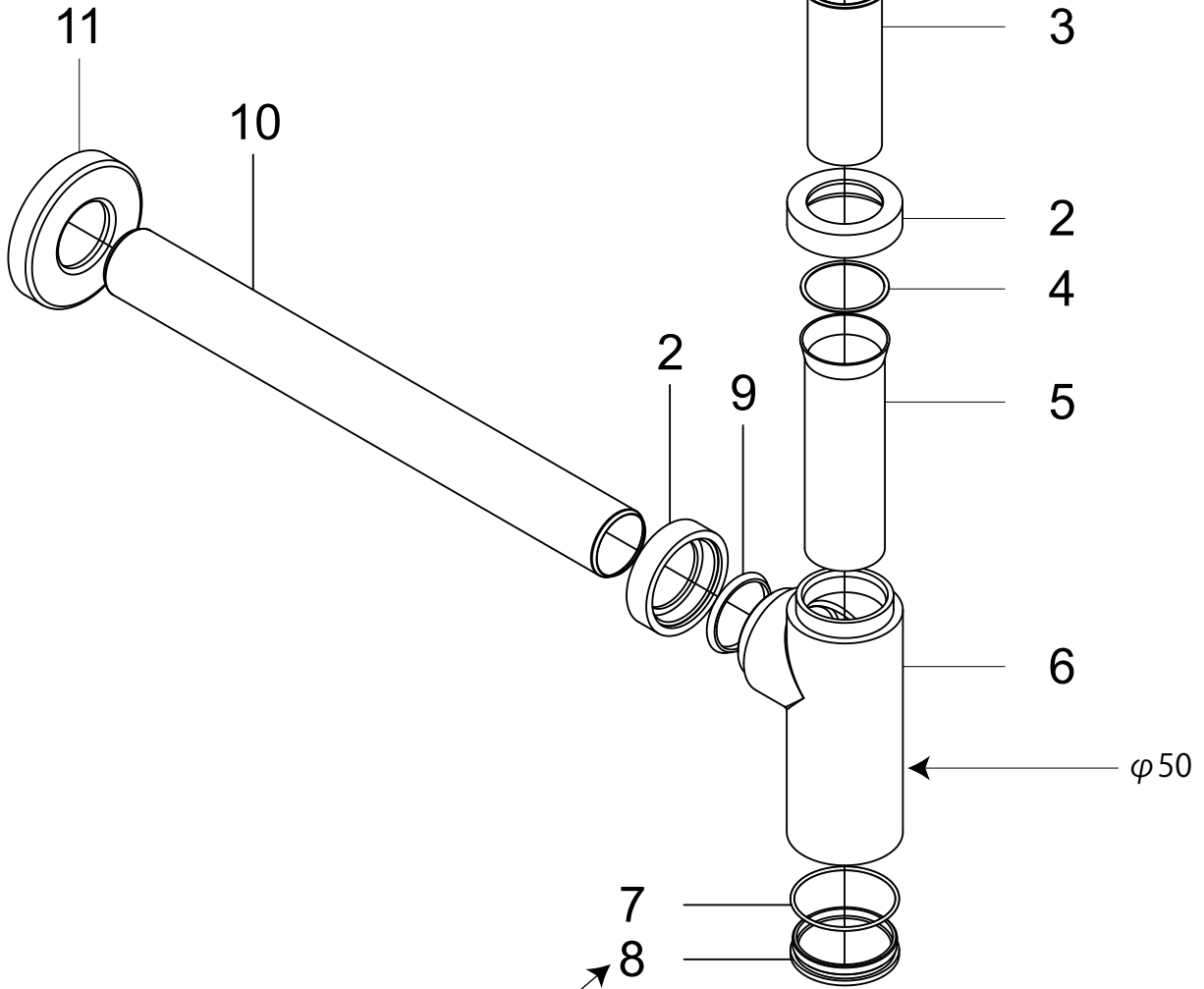
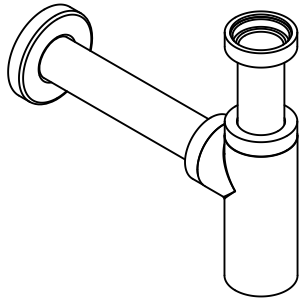

|      |              |  |       |             |
|------|--------------|--|-------|-------------|
| 11   | 090          | Rosone Ø70 - Flange Ø70                                | 1     | Brass-OT63  |
| 10   | 087          | Tubo ottone Ø32x300 - Pipe Ø32x300                     | 1     | Brass-OT63  |
| 9    | 222          | Guarnizione conica 1"1/4 - Conical washer 1"1/4        | 1     | NBR 70 SH   |
| 8    | 093          | Tappo ispezione 065 - Ispection plug 065               | 1     | Brass-OT58  |
| 7    | 221          | ORING 40x2   | 1     | NBR 70 SH   |
| 6    | 085          | Corpo Sifone 065 - Body Siphon 065                     | 1     | Brass-OT58  |
| 5    | 196          | Tubetto PVC 065 - PVC pipe 065                         | 1     | PVC plastic |
| 4    | 220          | Guarnizione fibra 1"1/4 - Fybre washer 1"1/4           | 1     | Fybre       |
| 3    | 095          | Tubo ottone c/flangia Ø32x85 - Pipe with flange Ø32x85 | 1     | Brass-OT63  |
| 2    | 091          | Calotta 1"1/4 Ø50 - Nut 1"1/4 Ø50                      | 3     | Brass-OT58  |
| 1    | 219          | Guarnizione PVC 1"1/4 - PVC Washer 1"1/4               | 1     | PVC plastic |
| Pos. | Drawing Cod. | Description  | Q.ty. | Material    |

DENOMINAZIONE

AWK73-9903

TOLL. GENERALI

-

MAT. -

N° COD. ART. -

SCALA -

TRAT. -

N° COD. C.TE -

DATA

24/04/2007



PESO

-

N° DISEGNO

E012

DISEGNATO

DiPi designs